

TIRE REPAIR PATCHES

YSQP is dedicated to manufacturing only the highest quality tire repair materials.

From the raw material to the finished product, production is closely monitored at every stage to ensure all of our finished products meet or exceed rigorous quality standards.

STANDARD PUNCTURE REPAIR PROCEDURES

Patch Repair Procedures

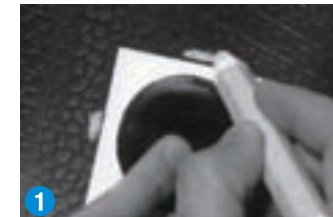

Center the repair unit over the injury on the inside of the tire and outline an area 1/4" larger than the patch to define the repair area.



Using pre-buff rubber cleaner and an inner liner scraper, thoroughly clean the outlined area, removing all mold lubricants, dirt, and debris.



Using a low speed buffer at no more than 5,000 rpm, buff the outlined area to an even, Be careful not to buff through the inner liner and expose the cord body plies of the tire. Vacuum away any buffing debris.

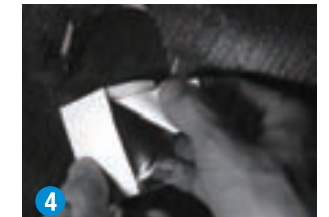

Relax the tire beads to their normal position. Remove the protective backing from the repair unit being careful not to touch the gum surface.



Using a roller stitcher, stitch the repair unit down firmly to the tire inner liner by working from the center outward making sure to remove all trapped air.

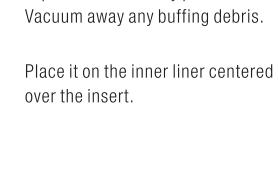

Place it on the inner liner centered over the insert.



Lead-wire combination units Repair Procedures



Select the appropriate repair material based on the size of the injury and the type of tire being repaired. Center the patch head over the injury on the inside of the tire and outline an area 1/4" larger than the patch to define the repair area.

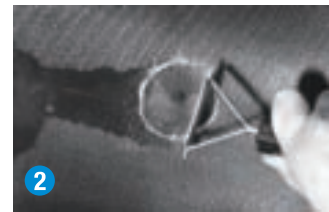

Using pre-buff rubber cleaner and an innerliner scraper, thoroughly clean the outlined area, removing all mold lubricants, dirt, and debris.



Using a low speed buffer at no more than 5,000 rpm, buff the outlined area to an even, Be careful not to buff through the inner liner and expose the cord body plies of the tire. Vacuum away any buffing debris.

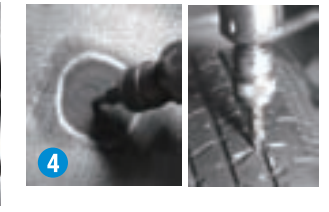

Using a 500 rpm low speed air drill and the appropriate carbide cutter, clear and prepare the injury channel by drilling it 3 times from the inside of the tire and then 3 times from the outside of the tire. This will clear away any damaged cables and prepares the injury channel to receive the vulcanizing insert (stem portion of the repair unit). Vacuum away any buffing debris.



Using a cement dipped probe, coat the wall of the injury channel with chemical vulcanizing cement. Using the brush applicator, apply cement to the prepared area of the inner liner in a stippling motion being careful not to puddle the cement. Allow the cement to dry thoroughly before installing the repair unit.



Relax the tire beads to their normal position. Remove the protective covering from the patch head and stem portions of the repair unit being careful not to touch the gum surfaces of the patch or stem.

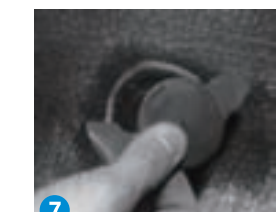

Place a drop of cement at the leading edge of the stem portion of the repair unit being careful not to puddle. This lubricates the repair unit as it is pulled through the injury channel.



Insert the lead wire into the injury channel from the inside of the tire and pull it from the outside of the tire with a pair of pliers. Pull the repair unit steadily from the outside of the tire until the patch head is seated. Do not dimple the patch head by pulling too far.



Using a roller stitcher, stitch the patch down firmly to the inner liner by working from the center outward making sure to remove all trapped air.



Keeping the stem in a relaxed position, cut the stem about 1/8" above the tread surface of the tire. Do not pull the stem while cutting.

TIRE REPAIR PATCHES



US STYLE RADIAL PATCHES

Designed to vulcanize chemically or in low temperature systems
Gray vulcanizing gum, blue poly backing

Part No.	PL	Size (Inch)	Size (mm)	Box Qty
YSP101	Radial 08, 1 Ply	1-5/8 x 3	45x76	20
YSP102	Radial 10, 1 Ply	2-3/8 x 3	57x76	20
YSP103	Radial 12, 1 Ply	2-1/4 x 4	57x102	10
YSP104	Radial 14, 1 Ply	3-3/4 x 4	95x102	10
YSP105	Radial 20, 1 Ply	2-7/8 x 5	76x125	10



US STYLE BIAS-PLY PATCHES

Designed primarily for use in agricultural bias ply tube or tubeless tires designed for chemical vulcanization

Part No.	PL	Size (Inch)	Size (mm)	Box Qty
YSP106	AG3, 2 Ply	3-1/2	90	20
YSP107	AG4, 2 Ply	4-1/2	115	10
YSP108	AG5, 2 Ply	5-1/2	140	10
YSP109	AG6, 3 Ply	6-1/2	165	10
YSP110	AG7, 4 Ply	7-1/2	190	10
YSP111	AG8, 4 Ply	8-1/2	215	10
YSP112	AG10, 6 Ply	10-1/2	265	5
YSP113	AG12, 6 Ply	12-1/2	317	5
YSP114	AG15, 8 Ply	15-1/2	394	1
YSP115	AG18, 8 Ply	18-1/2	470	1

UNIVERSAL SQUARE PATCHES

Designed for chemical vulcanization



Part No.	Square	Size (Inch)	Size (mm)	Box Qty
YSP116	Small Square	1-3/4	45	50
YSP117	Medium Square	2-1/8	55	25
YSP118	Large Square	3	75	15

UNIVERSAL ROUND PATCHES

Designed for chemical vulcanization



Part No.	Round	Size (Inch)	Size (mm)	Box Qty
YSP119	Small Round	1-5/8	41	30
YSP120	Medium Round	2-1/4	57	25
YSP121	Large Round	3-1/4	82	15

TUBE/TUBELESS TIRE REPAIRS PATCHES BLACK COLOUR WITH ORANGE BASE.

Designed for chemical or heat vulcanization, the Universal patches is a unit molded style repair unit with premium blue vulcanizing gum.
This repair is molded onto a white mylar backing which is slit for easy removal.



Part No.	Description	Size (mm)	Box Qty
YSP122	Tyre Patch	72x40	50
YSP123	Tyre Patch	50x32	50
YSP124	Tyre Patch	32x24	100

TIRE REPAIR PATCHES

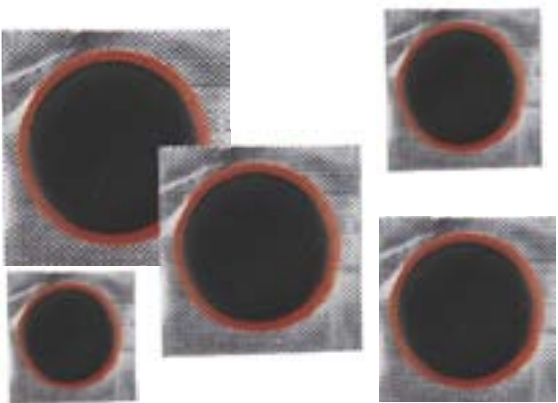

TUBE/TUBELESS TIRE REPAIRS PATCHES BLACK COLOUR WITH ORANGE BASE.

Designed for chemical or heat vulcanization, the Universal patches is a unit molded style repair unit with premium blue vulcanizing gum. This repair is molded onto a white mylar backing which is slit for easy removal.

Part No.	Description	Size (Inch)	Size (mm)	Box Qty
YSP125	Tyre Patch	1	Φ25	100
YSP126	Tyre Patch	1-1/4	Φ32	100
YSP127	Tyre Patch	1-5/8	Φ42	100
YSP128	Tyre Patch	2	Φ50	50
YSP129	Tyre Patch	2-3/8	Φ60	50

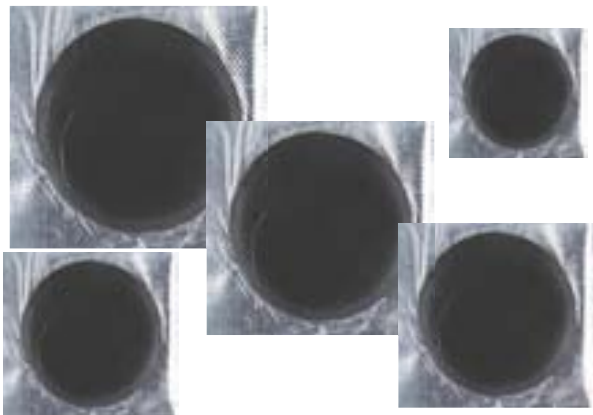

TUBE/TUBELESS TIRE REPAIRS PATCHES BLACK COLOR .

Designed for chemical or heat vulcanization, the Universal patches is a unit molded style repair unit with premium blue vulcanizing gum. This repair is molded onto a white mylar backing which is slit for easy removal.

Part No.	Description	Size (Inch)	Size (mm)	Box Qty
YSP130	Tyre Patch	1	Φ25	100
YSP131	Tyre Patch	1-1/4	Φ32	100
YSP132	Tyre Patch	1-5/8	Φ42	100
YSP133	Tyre Patch	2	Φ50	50
YSP134	Tyre Patch	2-3/8	Φ60	50

EASY CUT PATCHES

Use in Cold Vulcanization method;
Resisted to high temperature and having strong adhesive strength ;Patches can be to any size according to any injured place



Part No.	Description	Size (Inch)	Size (mm)	Box Qty
YSP135	Chemical Cure Only	2.5x6	75x150	30
YSP136	Chemical Cure Only	2x4	50x100	50
YSP137	Chemical Cure Only	1x2	25x50	100

EURO STYLE BIAS-PLY PATCHES

Each reinforcing ply is protected and encased in a molded ply package making each unit strong while remaining flexible
Designed to vulcanize chemically or in low temperature systems

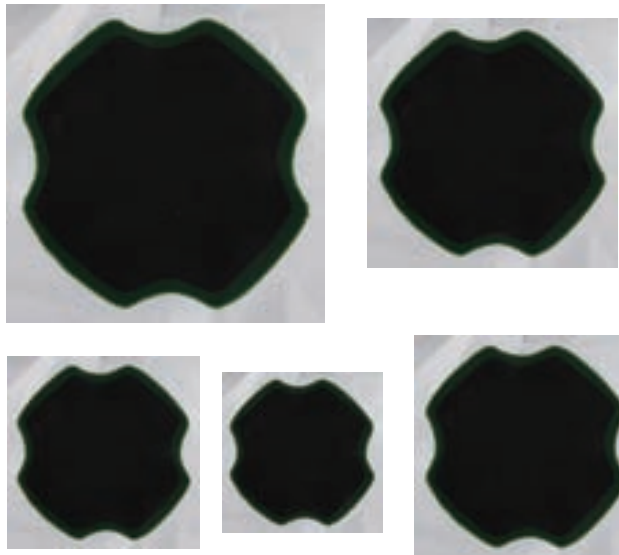

Part No.	Description	Size (Inch)	Size (mm)	Box Qty
YSP138	AG3, 2 Ply	3 1/2	90	20
YSP139	AG4, 2 Ply	4 1/2	115	10
YSP140	AG5, 2 Ply	5 1/2	140	10
YSP141	AG6, 3 Ply	6 1/2	165	10
YSP142	AG7, 4 Ply	7 1/2	190	10

STRING-TYPE INSERTS

LEAD-WIRE COMBINATION UNITS

Lead-wire combination units require no special wire pulling tools .Just insert the lead wire into the injury from the inside of the tire and pull the repair unit through from the out side .Both the stem and the repair unit are gum coated to provide the most complete bond ,both through the injury and on the inner liner . The lead-wire combination units are black with gray vulcanizing gum and will vulcanize chemically or in a heat curing system.

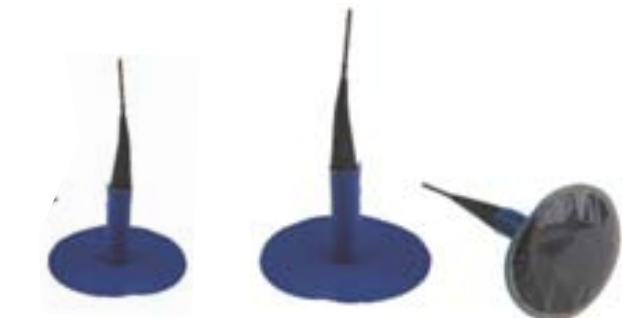

Part No.	Lenght(mm)	Dia	Box Qty	Case Qty
YSP143	25	Φ4mm	40	18
YSP144	34	Φ4mm	32	18
YSP145	34	Φ6mm	32	18
YSP146	42	Φ6mm	32	18
YSP147	50	Φ9mm	12	18
YSP148	62	Φ9mm	12	18

STRING-TYPE INSERTS

String-type inserts can be used in passenger or truck ,radial or bias-ply tires. Made of a butyl rubber ,these inserts are very strong , allowing easy insertion through steel belted radials , string-type inserts are temporary repairs ,sealing by compression only .Use any closed eye needle . To install all other string-type inserts ,use any end-slot needle (passenger length for 4"inserts;truck length for 8"inserts).



Part No.	Diameter	Size	Colour	Description
YSP149	Ø 3.5	8inch(200mm)	Black	A paper, a transparent film
YSP150	Ø 3.5	4inch(100mm)	Black	Two sides transparent film
YSP151	Ø 3.5	8inch(200mm)	brown	A paper, a transparent film
YSP152	Ø 3.5	4inch(100mm)	brown	Two sides transparent film
YSP153	Ø 6	8inch(200mm)	Black	A paper, a transparent film
YSP154	Ø 6	4inch(100mm)	Black	Two sides transparent film
YSP155	Ø 6	8inch(200mm)	brown	A paper, a transparent film
YSP156	Ø 6	4inch(100mm)	brown	Two sides transparent film

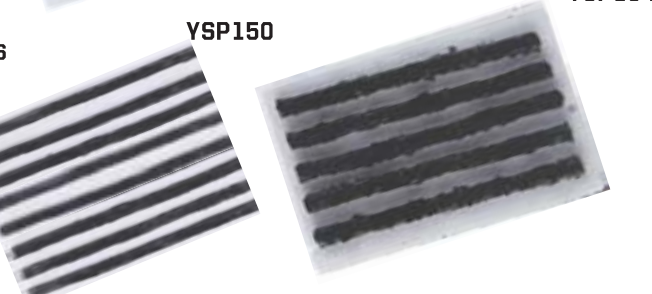
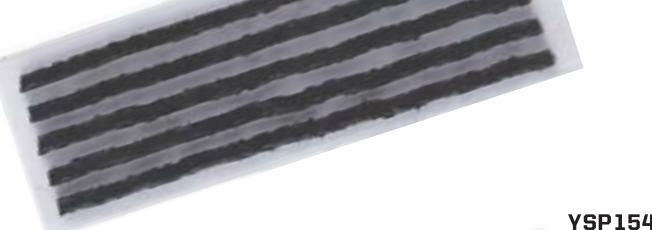
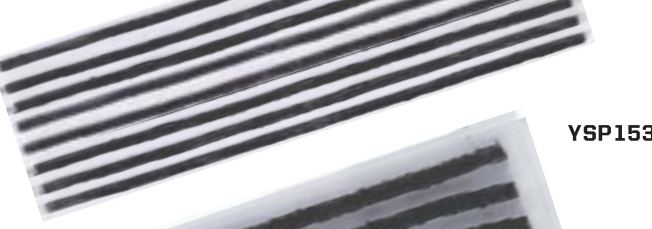
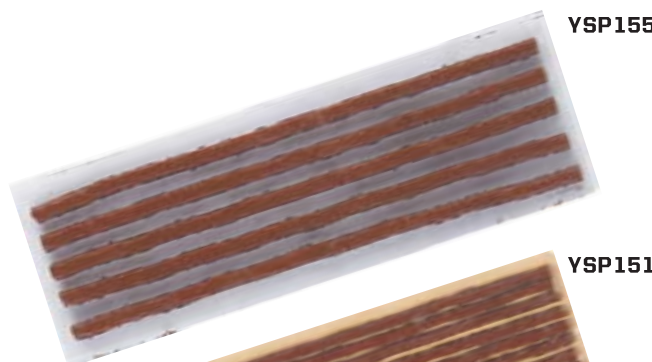
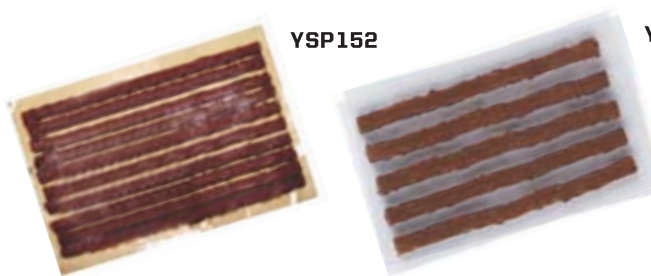

TIRE REPAIR CHEMICALS

MOUNTING AND DEMOUNTING COMPOUNDS

To prevent damage to tire beads, always use quality YSQP Mounting and Demounting Compounds. We offer an industry leading selection for the tire service professional.



Part No.	Description	Case Qty
YSP157	2.2 lb.(1kg) euro-paste,white	20
YSP158	6 1/2lb.(3kg) euro-paste,white	4
YSP159	11 lb.(5kg) euro-paste,white	4
YSP160	Lube	100
YSP161	8.8 lb.(4kg) euro-paste,white	4

RUBBER CEMENTS



REPAIR CHEMICAL

HEAVY DUTY SUPR-BLUVULCANIZING CEMENT

Contains more rubber solids than our regular cement for a stronger bond.

CHEMICAL VULCANIZING CEMENT

For chemical or heat vulcanization. The flammable vulcanizing cement is our most popular, fast dry cement. For use with any YSQP repair unit or insert. When used on large reinforced patches, coat patch and inner liner with cement.



Part No.	Description	Case Qty
YSP162	0.41oz 12ml rubber cement	500
YSP163	0.41oz 12ml rubber cement	500
YSP172	1oz 30ml rubber cement	200

BEAD SEALER

For sealing small air leaks between the tire beadand the wheel.

BUFFING SOLUTION-RUBBER PREP

For removing dirt, debris and mold lubricants from the repair area prior to buffing.

Part No.	Size	Description	Type	Case Qty
YSP164	8 oz. (236ml)	Chemical or heat vulcanization	Flammable	24
YSP165	32 oz. (945ml)	Chemical or heat vulcanization	Flammable	12
YSP166	8 oz. (236ml)	Heat vulcanization only	Flammable	24
YSP167	32 oz. (945ml)	Heat vulcanization only	Flammable	12
YSP168	32 oz. (945ml)	For sealing small air leaks	Flammable	12
YSP169	8 oz. (236ml)	Chemical or heat vulcanization	Flammable	24
YSP170	32 oz. (945ml)	Chemical or heat vulcanization	Flammable	12
YSP171	32 oz. (945ml)	for removing dirt ,debris and mold lubricants	Flammable	12